

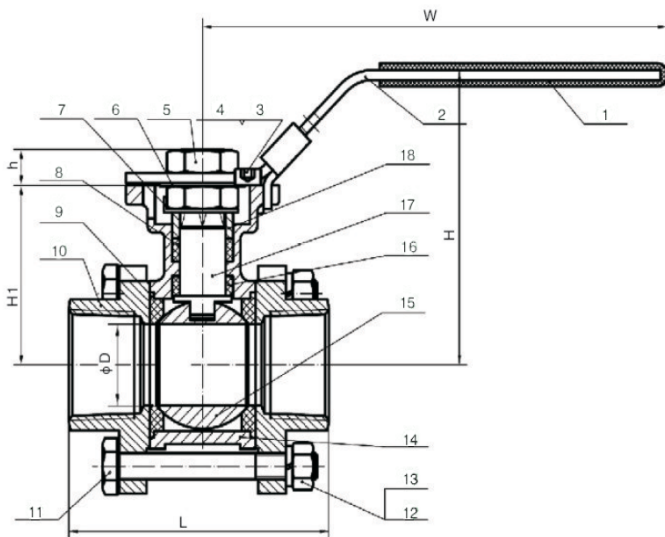

3PC Mounting Pad Full Port Ball Valve Screwed-ends, PN63, PSI1000

- Thread conform with EN 10226-1, ISO 7-1
- Blow-out proof stem/Full bore
- Mounting Pad For ISO 5211
- Investment casting
- CE PED tested with test report 3.1 EN 10204
- Ts: -40°C .. 120°C



No.	PART	MATERIAL
1	PLASTIC COVER	PLASTIC
2	HANDLE	SS304
3	POSITIONING BOLT	SS304
4	NUT	SS304
5	STEM NUT	SS304
6	GASKET	PTFE
7	LOCKING WASHER	SS304
8	STEM PACKING	PTFE
9	SEAT	PTFE
10	CAP	ASTM-A351-CF8M
11	BOLT	SS304
12	SPRING WASHER	SS304
13	BOLT NUT	SS304
14	BODY	ASTM-A351-CF8M
15	BALL	ASTM-A351-CF8M
16	STEM PACKING	PTFE
17	STEM	ASTM-A351-CF8M
18	GLAND	SS304

RP	Art. No.	D	H	W	H1	h	ISO5211		L
		mm							mm
1/4"	0183.0201	12.5	72	141	38.5	9	9	F03 F04	64
3/8"	0183.0202	12.5	72	141	38.5	9	9	F03 F04	64
1/2"	0183.0203	15	75	141	42	9	9	F03 F04	72
3/4"	0183.0204	20	81	141	48	9	9	F03 F04	80
1"	0183.0205	25	93	162	55	11	11	F04 F05	85
1 1/4"	0183.0206	32	98	162	60	11	11	F04 F05	105
1 1/2"	0183.0207	38	109	188	70	15	14	F05 F07	113
2"	0183.0208	50	124	188	85	15	14	F05 F07	132
2 1/2"	0183.0209	65	156	233	109	19	17	F07 F10	170
3"	0183.0210	76	165	233	118	19	17	F07 F10	186

