

Sight glass - Tubular type

with flanged connection acc. to DIN

Application:

Sight glass - Tubular type with flanges on both sides to use in either horizontal or vertical pipe lines for optical control of fluids and gasses.

Operating conditions:

Connection: Flanges PN 10 / 16
 Pressure: up to DN 100 - 6 bar max
 DN 125 and up – 4 bar max
 Temperature: 200°C max.

Installation:

Optional

Special designs:

Protection jacket of acrylic glass
 ANSI - Flanges
 Extra length

Materials:

Flanges	WN 1.4571	Steel H II
Screws	A4 - 70	Steel
Glass tube	Borosilicate glass	
Gaskets	Viton (PTFE or other materials)	

Ordering example:

Sight Glass - Tubular Type Bauform 20
 WN 1.4571, Gaskets Viton
 max. 6 bar / 200°C
 DN 50, PN 10

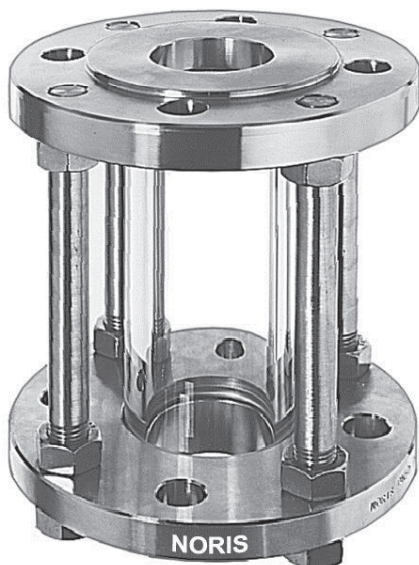
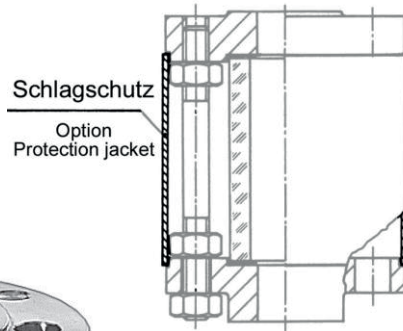
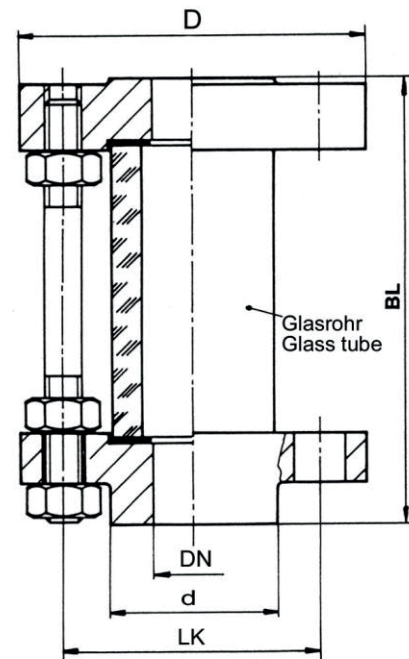
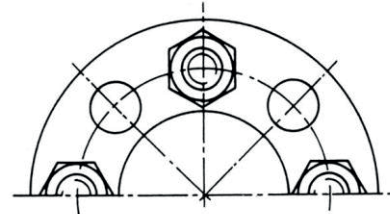

Dimensions:

DN	D	d	BL	Screws	LK
15	95	45	200	4	65
20	105	58	200	4	75
25	115	68	200	4	85
32	140	78	200	4	100
40	150	88	200	4	110
50	165	102	200	4	125
65	185	122	200	4	145
80	200	138	200	4	160
100	220	158	200	4	180
125	250	188	200	8	210
150	285	212	200	8	240
200	340	268	200	8	295

Mounting instructions:

Sight glass tubular type must be mounted without tension by tube, vibrations and pressure pushes.